

2. Panel processing

2.1 Edge processing 2.1.3 Compact hoggers - DP



Diamaster DT Premium

Application:

For hogging along and across grain - sizing - especially for **hogging / hogging**.

Machine:

Double-end tenoners, edgebanding machines etc.

Workpiece material:

Chip and fibre board (MDF etc.) uncoated, veneered, plastic and paper coated, light construction panels (honeycomb).

Technical information:

Maximum economic efficiency through long tool life even in different materials (batch size 1). Up to 15 times resharpenable and constant cutting width over the entire life cycle. Perfect edge quality and smooth cutting surfaces through adapted cutting geometries. Clean workpiece finishes due to efficient chip removal with DFC-technology. Hogger as standard with 4 pinholes reference diameter 100 and quick clamping system 160 (BO 60) and 192 (BO 80).

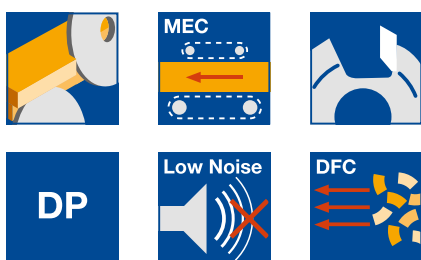

Diamaster DT Premium

HZ 210 2

| D | SB | BO | ZF | Z | v_f^* | ID | ID |
|-----|----|----|----|----|---------------------|--------|--------|
| mm | mm | mm | | | m min ⁻¹ | LH | RH |
| 250 | 10 | 60 | 1 | 24 | 30 | 190382 | 190383 |
| 250 | 10 | 60 | 1 | 30 | 35 | 190386 | 190387 |
| 250 | 10 | 60 | 1 | 36 | 40 | 190390 | 190391 |
| 250 | 10 | 60 | 1 | 42 | 45 | 190394 | 190395 |
| 250 | 10 | 60 | 1 | 48 | 50 | 190398 | 190399 |
| 250 | 10 | 60 | 1 | 54 | 60 | 190402 | 190403 |
| 250 | 10 | 60 | 1 | 60 | 80 | 190406 | 190407 |
| 250 | 10 | 60 | 2 | 24 | 30 | 190384 | 190385 |
| 250 | 10 | 60 | 2 | 30 | 35 | 190388 | 190389 |
| 250 | 10 | 60 | 2 | 36 | 40 | 190392 | 190393 |
| 250 | 10 | 60 | 2 | 42 | 45 | 190396 | 190397 |
| 250 | 10 | 60 | 2 | 48 | 50 | 190400 | 190401 |
| 250 | 10 | 60 | 2 | 54 | 60 | 190404 | 190405 |
| 250 | 10 | 60 | 2 | 60 | 80 | 190408 | 190409 |
| 250 | 10 | 80 | 1 | 24 | 30 | 190410 | 190411 |
| 250 | 10 | 80 | 1 | 30 | 35 | 190414 | 190415 |
| 250 | 10 | 80 | 1 | 36 | 40 | 190418 | 190419 |
| 250 | 10 | 80 | 1 | 42 | 45 | 190422 | 190423 |
| 250 | 10 | 80 | 1 | 48 | 50 | 190426 | 190427 |
| 250 | 10 | 80 | 1 | 54 | 60 | 190430 | 190431 |
| 250 | 10 | 80 | 1 | 60 | 80 | 190434 | 190435 |
| 250 | 10 | 80 | 2 | 24 | 30 | 190412 | 190413 |
| 250 | 10 | 80 | 2 | 30 | 35 | 190416 | 190417 |
| 250 | 10 | 80 | 2 | 36 | 40 | 190420 | 190421 |
| 250 | 10 | 80 | 2 | 42 | 45 | 190424 | 190425 |
| 250 | 10 | 80 | 2 | 48 | 50 | 190428 | 190429 |
| 250 | 10 | 80 | 2 | 54 | 60 | 190432 | 190433 |
| 250 | 10 | 80 | 2 | 60 | 80 | 190436 | 190437 |

Order example:

Hogging set D-250 mm, Z 36, right

Hogging set consisting of:

DT Premium hogger D-250 ID **190391**

Hydro clamping sleeve ID **061702**

Special information:

Including assembly, machine model

Tooth shape 1 (ZF 1):

For processing different materials (batch size 1), coated wood materials such as HPL, melamine, high gloss.

Tooth shape 2 (ZF 2):

For processing veneers, paper, honeycomb panels.

Further dimensions on request.

Standard flanged sleeves, hydro clamping elements, quick clamping and hydro quick clamping sleeves, see section Clamping Systems.

* Recommended feed rate.

Архангельск (8182)63-90-72
Астана (7172)727-132
Астрахань (8512)99-46-04
Барнаул (3852)73-04-60
Белгород (4722)40-23-64
Брянск (4832)59-03-52
Владивосток (423)249-28-31
Волгоград (844)278-03-48
Вологда (8172)26-41-59
Воронеж (473)204-51-73
Екатеринбург (343)384-55-89
Иваново (4932)77-34-06

Ижевск (3412)26-03-58
Иркутск (395)279-98-46
Казань (843)206-01-48
Калининград (4012)72-03-81
Калуга (4842)92-23-67
Кемерово (3842)65-04-62
Киров (8332)68-02-04
Краснодар (861)203-40-90
Красноярск (391)204-63-61
Курск (4712)77-13-04
Липецк (4742)52-20-81
Киргизия (996)312-96-26-47

Магнитогорск (3519)55-03-13
Москва (495)268-04-70
Мурманск (8152)59-64-93
Набережные Челны (8552)20-53-41
Нижний Новгород (831)429-08-12
Новокузнецк (3843)20-46-81
Новосибирск (383)227-86-73
Омск (3812)21-46-40
Орел (4862)44-53-42
Оренбург (3532)37-68-04
Пенза (8412)22-31-16
Россия (495)268-04-70

Пермь (342)205-81-47
Ростов-на-Дону (863)308-18-15
Рязань (4912)46-61-64
Самара (846)206-03-16
Санкт-Петербург (812)309-46-40
Саратов (845)249-38-78
Севастополь (8692)22-31-93
Симферополь (3652)67-13-56
Смоленск (4812)29-41-54
Сочи (862)225-72-31
Ставрополь (8652)20-65-13
Казахстан (772)734-952-31

Сургут (3462)77-98-35
Тверь (4822)63-31-35
Томск (3822)98-41-53
Тула (4872)74-02-29
Тюмень (3452)66-21-18
Ульяновск (8422)24-23-59
Уфа (347)229-48-12
Хабаровск (4212)92-98-04
Челябинск (351)202-03-61
Череповец (8202)49-02-64
Ярославль (4852)69-52-93

2. Panel processing

2.1 Edge processing 2.1.3 Compact hoggers - DP

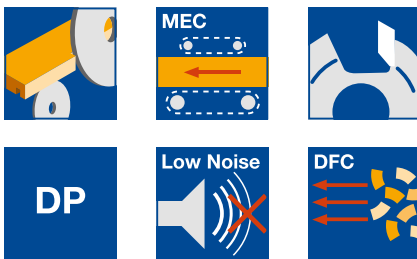

Order example:

Hogging set D-250 mm, Z 36, right
Hogging set consisting of:
DT Premium Score hogger D-250
ID **190443**
Hydro clamping sleeve ID **061702**

Special information:

Including assembly, machine model

Tooth shape 1 (ZF 1):

For processing different materials (batch size 1), coated wood materials such as HPL, melamine, high gloss.

Tooth shape 2 (ZF 2):

For processing veneers, paper, honeycomb panels.

Diamaster DT Premium Score

Application:

For hogging along and across grain - sizing - especially for **scoring / hogging**.

Machine:

Double-end tenoners, edgebanding machines etc.

Workpiece material:

Chip and fibre board (MDF etc.) uncoated, veneered, plastic and paper coated, light construction panels (honeycomb).

Technical information:

Maximum economic efficiency through long tool life even in different materials (batch size 1). Up to 15 times resharpenable and constant cutting width over the entire life cycle. Perfect edge quality and smooth cutting surfaces through adapted cutting geometries. Clean workpiece finishes due to efficient chip removal with DFC-technology. Hogger as standard with 4 pinholes reference diameter 100 and quick clamping system 160 (BO 60) and 192 (BO 80).

Diamaster DT Premium Score

HZ 210 2

| D | SB | BO | ZF | Z | v_f^* | ID | ID |
|-----|----|----|----|----|---------------------|---------------|---------------|
| mm | mm | mm | | | m min ⁻¹ | LH | RH |
| 250 | 10 | 60 | 1 | 24 | 18 | 190438 | 190439 |
| 250 | 10 | 60 | 1 | 36 | 25 | 190442 | 190443 |
| 250 | 10 | 60 | 1 | 48 | 30 | 190446 | 190447 |
| 250 | 10 | 60 | 1 | 60 | 40 | 190450 | 190451 |
| 250 | 10 | 60 | 2 | 24 | 18 | 190440 | 190441 |
| 250 | 10 | 60 | 2 | 36 | 25 | 190444 | 190445 |
| 250 | 10 | 60 | 2 | 48 | 30 | 190448 | 190449 |
| 250 | 10 | 60 | 2 | 60 | 40 | 190452 | 190453 |
| 250 | 10 | 80 | 1 | 24 | 18 | 190454 | 190455 |
| 250 | 10 | 80 | 1 | 36 | 25 | 190458 | 190459 |
| 250 | 10 | 80 | 1 | 48 | 30 | 190462 | 190463 |
| 250 | 10 | 80 | 1 | 60 | 40 | 190466 | 190467 |
| 250 | 10 | 80 | 2 | 24 | 18 | 190456 | 190457 |
| 250 | 10 | 80 | 2 | 36 | 25 | 190460 | 190461 |
| 250 | 10 | 80 | 2 | 48 | 30 | 190464 | 190465 |
| 250 | 10 | 80 | 2 | 60 | 40 | 190468 | 190469 |

Further dimensions and version with veneer cutting edges (FUZ) on request.

Standard flanged sleeves, hydro clamping elements, quick clamping and hydro quick clamping sleeves, see section Clamping Systems.

* Recommended feed rate.

2. Panel processing

2.1 Edge processing 2.1.3 Compact hoggers - DP



Compact hogger

Application:

For hogging along and across grain - for sizing applications in double hogging process (**hogging / hogging**).

Machine:

Double-end tenoners, edgebanding machines etc.

Workpiece material:

Particle and fibre materials (MDF etc.) uncoated, veneered, plastic and paper coated, lightweight panels (honeycomb).

Technical information:

Resharpenable 10 times. **Tooth with decreasing bevel** for higher cutting performance, particularly suitable for materials with a loose middle layer. **Tooth with increasing bevel** for maximum stability, particularly suitable for materials with high mineral content and boards with a large material overhang.

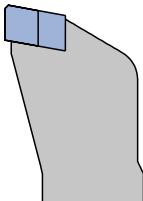
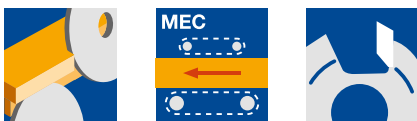

Tooth with decreasing bevel for higher cutting performance, particularly suitable for material with a loose middle layer.

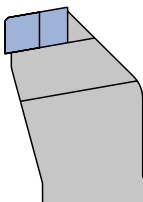

Tooth with increasing bevel for maximum stability, particularly suitable for materials with high mineral content and boards with large material overhang. At decreasing bevel and low overlap remain strips, which won't be hogged.

For mounting on hydro clamping or hydro quick clamping sleeve

HZ 210 2

| D | SB | BO | Z | ZF | v_f^* | ID | ID |
|-----|----|----|----|------------|---------------|---------------|---------------|
| mm | mm | mm | | | $m\ min^{-1}$ | LH | RH |
| 250 | 10 | 60 | 35 | decreasing | 35 | 190358 | 190359 |
| 250 | 10 | 60 | 45 | decreasing | 45 | 190360 | 190361 |
| 250 | 10 | 60 | 55 | decreasing | 55 | 190362 | 190363 |
| 253 | 10 | 60 | 35 | increasing | 35 | 190364 | 190365 |
| 253 | 10 | 60 | 45 | increasing | 45 | 190366 | 190367 |
| 253 | 10 | 60 | 55 | increasing | 55 | 190368 | 190369 |

For mounting on flanged sleeve or quick clamping sleeve

HZ 210 2

| D | SB | BO | Z | ZF | v_f^* | ID | ID |
|-----|----|----|----|------------|---------------|---------------|---------------|
| mm | mm | mm | | | $m\ min^{-1}$ | LH | RH |
| 250 | 10 | 80 | 35 | decreasing | 35 | 190370 | 190371 |
| 250 | 10 | 80 | 45 | decreasing | 45 | 190372 | 190373 |
| 250 | 10 | 80 | 55 | decreasing | 55 | 190374 | 190375 |
| 253 | 10 | 80 | 35 | increasing | 35 | 190376 | 190377 |
| 253 | 10 | 80 | 45 | increasing | 45 | 190378 | 190379 |
| 253 | 10 | 80 | 55 | increasing | 55 | 190380 | 190381 |

Standard flanged sleeves, hydro clamping, quick clamping and hydro quick clamping sleeves, see Lexicon section Clamping Systems.

* Recommended feed rate for coated chipboard materials and fibre materials.

Архангельск (8182)63-90-72
Астана (7172)727-132
Астрахань (8512)99-46-04
Барнаул (3852)73-04-60
Белгород (4722)40-23-64
Брянск (4832)59-03-52
Владивосток (423)249-28-31
Волгоград (844)278-03-48
Вологда (8172)26-41-59
Воронеж (4712)204-51-73
Екатеринбург (343)384-55-89
Иваново (4932)77-34-06

Ижевск (3412)26-03-58
Иркутск (395)279-98-46
Казань (843)206-01-48
Калининград (4012)72-03-81
Калуга (4842)92-23-67
Кемерово (3842)65-04-62
Киров (8332)68-02-04
Краснодар (861)203-40-90
Красноярск (391)204-63-61
Курск (4712)77-13-04
Липецк (4742)52-20-81
Киргизия (996)312-96-26-47

Магнитогорск (3519)55-03-13
Москва (495)268-04-70
Мурманск (8152)59-64-93
Набережные Челны (8552)20-53-41
Нижний Новгород (831)429-08-12
Новокузнецк (3843)20-46-81
Новосибирск (383)227-86-73
Омск (3812)21-46-40
Орел (4862)44-53-42
Оренбург (3532)37-68-04
Пенза (8412)22-31-16
Россия (495)268-04-70

Пермь (342)205-81-47
Ростов-на-Дону (863)308-18-15
Рязань (4912)46-61-64
Самара (846)206-03-16
Санкт-Петербург (812)309-46-40
Саратов (845)249-38-78
Севастополь (8692)22-31-93
Симферополь (3652)67-13-56
Смоленск (4812)29-41-54
Сочи (862)225-72-31
Ставрополь (8652)20-65-13
Казахстан (772)734-952-31

Сургут (3462)77-98-35
Тверь (4822)63-31-35
Томск (3822)98-41-53
Тула (4872)74-02-29
Тюмень (3452)66-21-18
Ульяновск (8422)24-23-59
Уфа (347)229-48-12
Хабаровск (4212)92-98-04
Челябинск (351)202-03-61
Череповец (8202)49-02-64
Ярославль (4852)69-52-93