



Segment hogger for sizing unit

Application:

For hogging along and across grain with/without scoring sawblade.

Machine:

Sizing station in production lines.

Workpiece material:

Chip and fibre boards (MDF etc.) uncoated, veneered, plastic coated.

Technical information:

The cut edge quality depends on the circular sawblade. Tool body D 305 mm in steel or D 355 mm in aluminium. Staggered cut with six tungsten carbide segments. Build up option with extension hogger unit. For D 305 mm the hogger is mounted directly on the spindle without flanged sleeve.



Hogger for sizing unit

SZ 300 2, SZ 301 2

| Machine | D | SB | BO | Z/ZF _{Sawblade} | QAL | ID | ID |
|-------------|-----|------|--------|--------------------------|-----|--------|--------|
| | mm | mm | mm | | | LH | RH |
| Siempelkamp | 305 | 60.1 | 30 | 60/ES | HW | 064700 | 064701 |
| Siempelkamp | 355 | 60.5 | 40 DKN | 72/ES | HW | 064702 | 064703 |



Spare parts:

| Part-no. | BEZ | ABM | BEM | ID |
|----------|-----------------------------|-------|-------------------------|----------|
| | | mm | | |
| 1 | Countersink screw, Torx® 20 | M6x12 | Torx® 20 | 006084 ● |
| 2 | Screw with ISK | M8x17 | for D = 250/350/305/355 | 006237 ● |
| 3 | Cylindrical screw with ISK | M8x60 | for D = 305 | 005878 ● |
| 3 | Cylindrical screw with ISK | M8x35 | for D = 305/350 | 005874 ● |
| 3 | Cylindrical screw with ISK | M8x25 | for D = 355 | 005947 ● |

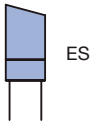

Hogging sawblade

WK 801 2

| D | SB | BO | Z | ZF | QAL | ID | ID |
|-----|-----|-----|----|----|-----|----------|----------|
| mm | mm | mm | | | | LH | RH |
| 305 | 4.4 | 120 | 60 | ES | HW | 061844 ● | 061845 ● |
| 355 | 4.4 | 80 | 72 | ES | HW | 061846 ● | 061847 ● |

Technical information:

Steel (D 300 mm) and aluminium (D 350 mm) with segments.

Basic hogger

WZ 300 2

| D | SB | BO | Z | ZF | QAL | ID | ID |
|-----|------|----|------|----|-----|--------|--------|
| mm | mm | mm | | | | LH | RH |
| 300 | 28 | 30 | 6x7 | FZ | HW | 064440 | 064441 |
| 350 | 36.5 | 80 | 6x10 | FZ | HW | 064442 | 064443 |

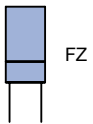

Extension hogger

WZ 300 2

| D | SB | BO | Z | ZF | QAL | ID | ID |
|-----|------|----|------|----|-----|----------|--------|
| mm | mm | mm | | | | LH | RH |
| 300 | 28 | 30 | 6x7 | FZ | HW | 064444 | 064445 |
| 350 | 20.2 | 80 | 6x10 | FZ | HW | 064446 ● | 064447 |

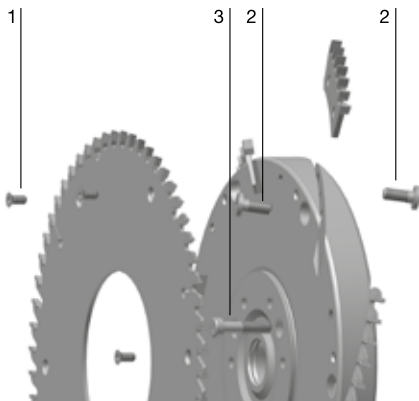

Segments (6 per hogger)

TM 170 0

| ABM | Z | ZF | QAL | ID | ID |
|-----------|----|----|-----|----------|----------|
| mm | | | | LH | RH |
| D 300/340 | 7 | FZ | HW | 064970 ● | 064971 ● |
| D 350 | 10 | FZ | HW | 064962 ● | 064963 ● |

Архангельск (8182)63-90-72
Астана (7172)727-132
Астрахань (8512)99-46-04
Барнаул (3852)73-04-60
Белгород (4722)40-23-64
Брянск (4832)59-03-52
Владивосток (423)249-28-31
Волгоград (844)278-03-48
Вологда (8172)26-41-59
Воронеж (473)204-51-73
Екатеринбург (343)384-55-89
Иваново (4932)77-34-06

Ижевск (3412)26-03-58
Иркутск (395)279-98-46
Казань (843)206-01-48
Калининград (4012)72-03-81
Калуга (4842)92-23-67
Кемерово (3842)65-04-62
Киров (8332)68-02-04
Краснодар (861)203-40-90
Красноярск (391)204-63-61
Курск (4712)77-13-04
Липецк (4742)52-20-81
Киргизия (996)312-96-26-47

Магнитогорск (3519)55-03-13
Москва (495)268-04-70
Мурманск (8152)59-64-93
Набережные Челны (8552)20-53-41
Нижний Новгород (831)429-08-12
Новокузнецк (3843)20-46-81
Новосибирск (383)227-86-73
Омск (3812)21-46-40
Орел (4862)44-53-42
Оренбург (3532)37-68-04
Пенза (8412)22-31-16
Россия (495)268-04-70

Пермь (342)205-81-47
Ростов-на-Дону (863)308-18-15
Рязань (4912)46-61-64
Самара (846)206-03-16
Санкт-Петербург (812)309-46-40
Саратов (845)249-38-78
Севастополь (8692)22-31-93
Симферополь (3652)67-13-56
Смоленск (4812)29-41-54
Сочи (862)225-72-31
Ставрополь (8652)20-65-13
Казахстан (772)734-952-31

Сургут (3462)77-98-35
Тверь (4822)63-31-35
Томск (3822)98-41-53
Тула (4872)74-02-29
Тюмень (3452)66-21-18
Ульяновск (8422)24-23-59
Уфа (347)229-48-12
Хабаровск (4212)92-98-04
Челябинск (351)202-03-61
Череповец (8202)49-02-64
Ярославль (4852)69-52-93