



Segment hoggers

Application:

For tear-free sizing along and across grain. Machining against feed only combined with scoring sawblade. Defined trimming in front of the finger cut for adjusting the finger fit.

Machine:

Double-end tenoners, finger joint machine with trimming aggregate, plug cutter.

Workpiece material:

All types of solid wood, chip and fibre boards (MDF etc.) raw, veneered, plastic and paper coated.

Technical information:

Steel tool body with HW circular sawblade and segment hogging elements. Staggered cut through six hogger segments. Mounted on flanged sleeve. Can be extended for larger hogging width. Single sided bevel tooth shape to improve the cutting quality and to reduce tear outs.

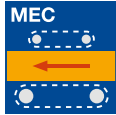

Steel basic and extension hoggers without flanged sleeve

WZ 300 2

D	SB	BO	Z	ZF	QAL	ID	ID
mm	mm	mm				LH	RH
250	26.0	80	6x7	FZ	HW	064410 ●	064411 ●
300	31.5	30	6x9	FZ	HW	064412 ●	064413 ●
350	36.5	30	6x10	FZ	HW	064414 ●	064415 ●

Spare parts:

Part- no.	BEZ	ABM	BEM	ID
		mm		
1	Spacer	115x5x80		028046 ●
2	Cylindrical screw with ISK	M8x20		005946 ●
3	Countersink screw, Torx® 20	M6x10	Torx® 20	006083 ●
4	Screw with ISK	M8x17	for D = 250/350/305/355	006237 ●
5	Allen key	SW 6		005494 ●
6	Torx® key	Torx® 20		117503 ●

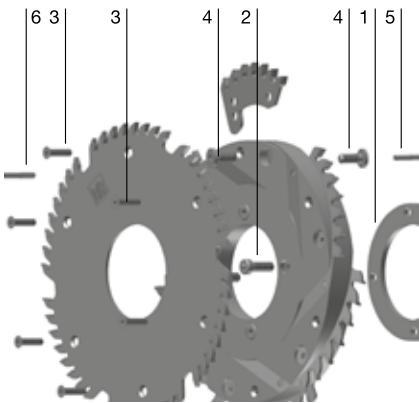

Spare circular sawblade for segment hogging set

WK 800 2 45, WK 800 2 46, WK 801 2, WK 850 2 45

D	SB	BO	Z	ZF	QAL	ID	ID
mm	mm	mm				LH	RH
250	3.2	80	42	WZ	HW	058219	058220
250	4.4	80	48	FZ	HW	061831 ●	061832 ●
250	4.4	80	48	ES	HW	061878 ●	061879 ●
250	4.4	80	66	FZ	HW	061953 ●	061954 ●
260	4.4	80	48	ES	HW	061963	061964
260	4.4	80	66	ES	HW	061965 ●	061966 ●
300	4.4	30	42	FZ	HW	061833	061834
300	3.2	30	54	WZ	HW	058221 ●	058222 ●
300	4.4	30	66	FZ	HW	061055 ●	061056 ●
350	3.2	30	66	WZ	HW	058223 ●	058224 ●

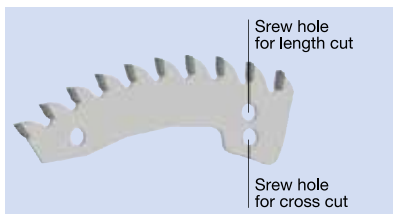
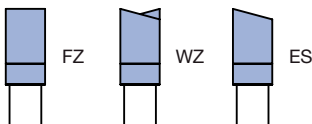

Spare segments for segment hogger

TM 170 0

BEZ	ABM	SB	QAL	ZF	Z	ID	ID
	mm	mm				LH	RH
Hogging segment	D 250	5.7	HW	FZ	7	064958 ●	064959 ●
Hogging segment	D 300	5.7	HW	FZ	9	064960 ●	064961 ●
Hogging segment	D 350	5.7	HW	FZ	10	064962 ●	064963 ●

Spare segments for segment hogger

Архангельск (8182)63-90-72
Астана (7172)727-132
Астрахань (8512)99-46-04
Барнаул (3852)73-04-60
Белгород (4722)40-23-64
Брянск (4832)59-03-52
Владивосток (423)249-28-31
Волгоград (844)278-03-48
Волгодонск (8172)26-41-59
Воронеж (473)204-51-73
Екатеринбург (343)384-55-89
Иваново (4932)77-34-06

Ижевск (3412)26-03-58
Иркутск (395)279-98-46
Казань (843)206-01-48
Калининград (4012)72-03-81
Калуга (4842)92-23-67
Кемерово (3842)65-04-62
Киров (8332)68-02-04
Краснодар (861)203-40-90
Красноярск (391)204-63-61
Курск (4712)77-13-04
Липецк (4742)52-20-81
Киргизия (996)312-96-26-47

Магнитогорск (3519)55-03-13
Москва (495)268-04-70
Мурманск (8152)59-64-93
Набережные Челны (8552)20-53-41
Нижний Новгород (831)429-08-12
Новокузнецк (3843)20-46-81
Новосибирск (383)227-86-73
Омск (3812)21-46-40
Орел (4862)44-53-42
Оренбург (3532)37-68-04
Пенза (8412)22-31-16
Россия (495)268-04-70

Пермь (342)205-81-47
Ростов-на-Дону (863)308-18-15
Рязань (4912)46-61-64
Самара (846)206-03-16
Санкт-Петербург (812)309-46-40
Саратов (845)249-38-78
Севастополь (8692)22-31-93
Симферополь (3652)67-13-56
Смоленск (4812)29-41-54
Сочи (862)225-72-31
Ставрополь (8652)20-65-13
Казахстан (772)734-952-31

Сургут (3462)77-98-35
Тверь (4822)63-31-35
Томск (3822)98-41-53
Тула (4872)74-02-29
Тюмень (3452)66-21-18
Ульяновск (8422)24-23-59
Уфа (347)229-48-12
Хабаровск (4212)92-98-04
Челябинск (351)202-03-61
Череповец (8202)49-02-64
Ярославль (4852)69-52-93